

REV.	DESCRIPTION	DRAWN	CHECKED	APPROVED
A	NEW RELEASE	ZQJ 11/18/2014	~	ZQJ 11/18/2014
B	ADD P/N 0008	CJJ 11/18/2014	~	

NOTES:

- MATERIAL&FINISHES
  - INSULATOR:THERMOPLASTIC(UL 94V-0).
  - CONTACT MATERIAL: COPPER ALLOY.
- SPECIFICATION
  - CURRENT RATING:1.5 Amp.
  - INSULATION RESISTANCE:1000MΩ Min.
  - DIELECTRIC WITHSTANDING:600VAC.
  - CONTACT RESISTANCE:20mΩ Max.
  - OPERATING TEMPERATURE:-40°C TO +105°C.

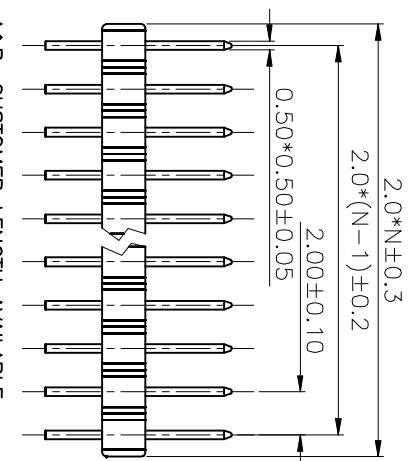

A&B: CUSTOMER LENGTH AVAILABLE  
N: NUMBER OF CONTACTS/2

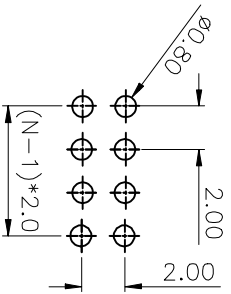
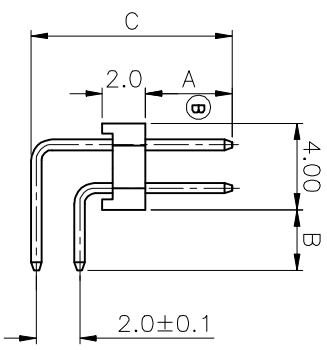

RECOMMEND PCB LAYOUT  
(TOLERANCE=±0.05)

TABLE A

TYPE	Dimension			Pin Length
	A	B	C	
1	4.00	2.80	9.30	10.70
2	6.00	2.80	11.30	12.70
3	2.42	5.00	12.70	16.70
4	3.70	3.00	9.00	10.30
5	3.20	3.00	9.20	10.50
6	8.00	2.80	13.30	14.70
7	3.50	3.00	9.25	10.50
8	4.00	4.00	9.30	11.70
9				15.70
10				

GENERAL TOLERANCE	ANGLE TOLERANCE	TOLERANCE
X. ±0.60	X. ±5°	±5°
.X ±0.38	X. ±3°	±3°
.XX ±0.25	.XX ±2°	±2°

PROJECTION	TITLE
UNITS	20MM PIN HEADER DUAL ROW
SHEET SIZE	R/A Type
	LL1011-4

慈溪蓝翎电子有限公司  
CIXI LANLING ELECTRONICS CO., LTD.

