

REV.	DESCRIPTION	DRAWN	CHECKED	APPROVED
A	NEW RELEASE	ZQJ 11/18/2014	~	ZQJ 11/18/2014
B	ADD P/N CODE	CJJ 11/18/2014	~	

N=NUMBER OF CONTACTS/2

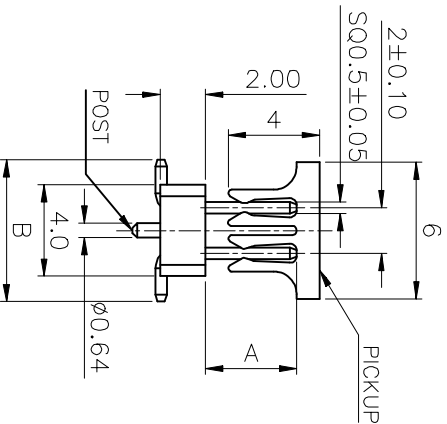

TYPE	DIM A	DIM B
1	4.00	6.20
2	3.50	6.20

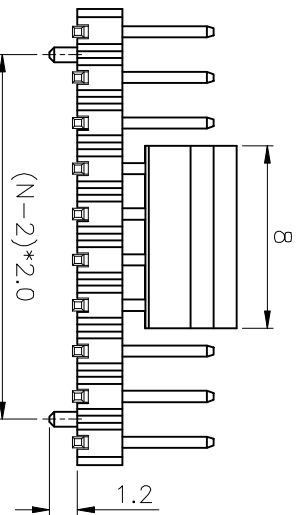
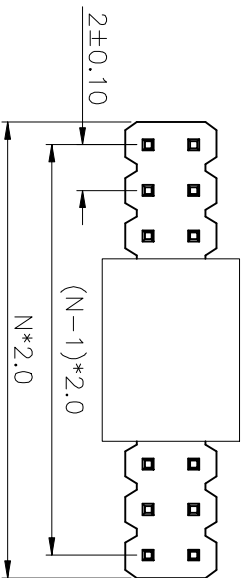
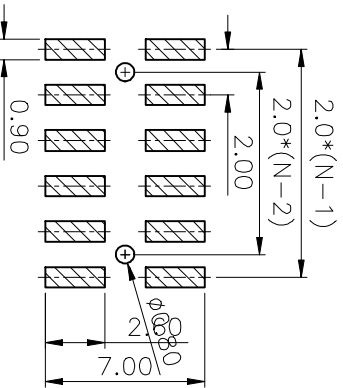

RECOMMEND PCB LAYOUT
(TOLERANCE=±0.05)

- NOTES:
- MATERIAL
 - INSULATOR: THERMOPLASTIC(U. 94V-0).
 - CONTACT MATERIAL: COPPER ALLOY.
 - SPECIFICATION
 - CURRENT RATING: 1.5 Amp.
 - INSULATION RESISTANCE: 1000MΩ Min.
 - DIELECTRIC WITHSTANDING: 600VAC.
 - CONTACT RESISTANCE: 20mΩ Max.
 - OPERATING TEMPERATURE: -40°C TO +105°C.

GENERAL TOLERANCE		ANGLE TOLERANCE		PROJECTION	
X, .X	±0.60	X, .X	±5°	UNITS	mm
.XX	±0.38	.XX	±3°	SHEET SIZE	A4
	±0.25		±2°		
DRAWING TYPE CUSTOMER		TITLE		2.0 PITCH PIN HEADER SMT TYPE	
SCALE	1:1	SHEET	1 OF 1	DUAL ROW W/O LOCATE PEG	
DRAWING NO.				SERIES LL1011-6A	



慈溪蓝翎电子有限公司
CIXI LANLING ELECTRONICS CO., LTD.