

REV.	DESCRIPTION	DRAWN	CHECKED	APPROVED
A	NEW RELEASE	ZQJ 11/18/2014	~	ZQJ 11/18/2014
B	ADD P/N CODE	CJJ 11/18/2014	~	

NOTES:

1. MATERIAL
 - 1.1 INSULATOR:THERMOPLASTIC (UL 94V-0).
 - 1.2 CONTACT MATERIAL:COPPER ALLOY.
2. SPECIFICATION
 - 2.1 CURRENT RATING:1.0 Amp.
 - 2.2 INSULATION RESISTANCE:500MΩ Min.
 - 2.3 DIELECTRIC WITHSTANDING:600VAC.
 - 2.4 CONTACT RESISTANCE:20mΩ Max.
 - 2.5 OPERATING TEMPERATURE:-40°C TO +105°C.

TYPE	DIM	A
1	2.50	
2		
3		
4		
5		
6		

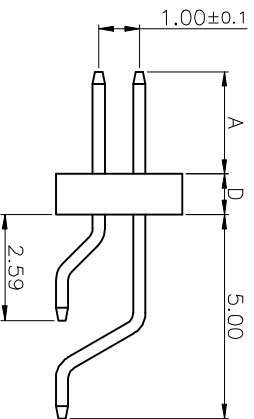
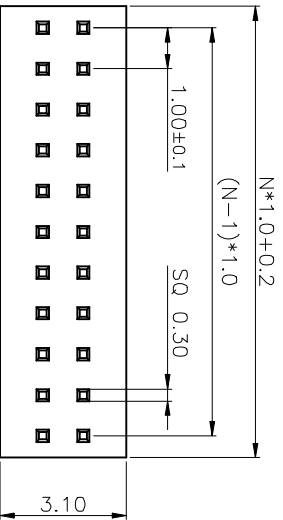
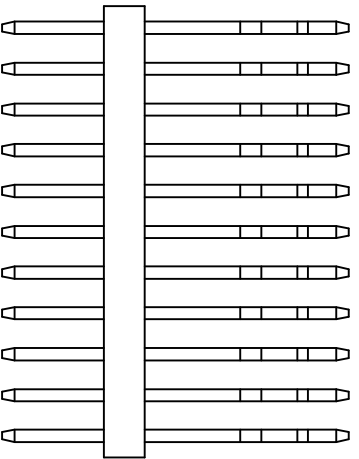

GENERAL TOLERANCE		ANGLE		TOLERANCE	
X	±0.60	X	±5°		
.X	±0.38	X	±3°		
.XX	±0.25	.XX	±2°		
DRAWING TYPE		CUSTOMER			
SCALE	1:1	SHEET	1 OF 1		
DRAWING NO.					

PROJECTION	TITLE
UNITS	DUAL ROW PIN HEADER
SHEET SIZE	PITCH 1.0mm SMT TYPE
A4	SERIES LL1013-04G

慈溪蓝翎电子有限公司
CIXI LANLING ELECTRONICS CO., LTD.