

REV.	DESCRIPTION	DRAWN	CHECKED	APPROVED
A	NEW RELEASE	ZQJ 11/18/2014	~	ZQJ 11/18/2014
B		CJJ 11/18/2014	~	ZQJ 11/18/2014
C		CJJ 11/18/2014	~	

NOTES:

- ELECTRICAL CHARACTERISTICS:
 - CONTACT RESISTANCE: 20mΩ Max. INITIAL.
 - DIELECTRIC WITHSTANDING VOLTAGE: 500V AC(rms) FOR 1 MINUTE.
 - INSULATION RESISTANCE: 1000MΩ Min.
- ENVIRONMENT CHARACTERISTICS:

TEMPERATURE RANGE: -40°C~+105°C.
- PRODUCT NUMBER CODE:

LL1007 - X X X X X X X - X - X

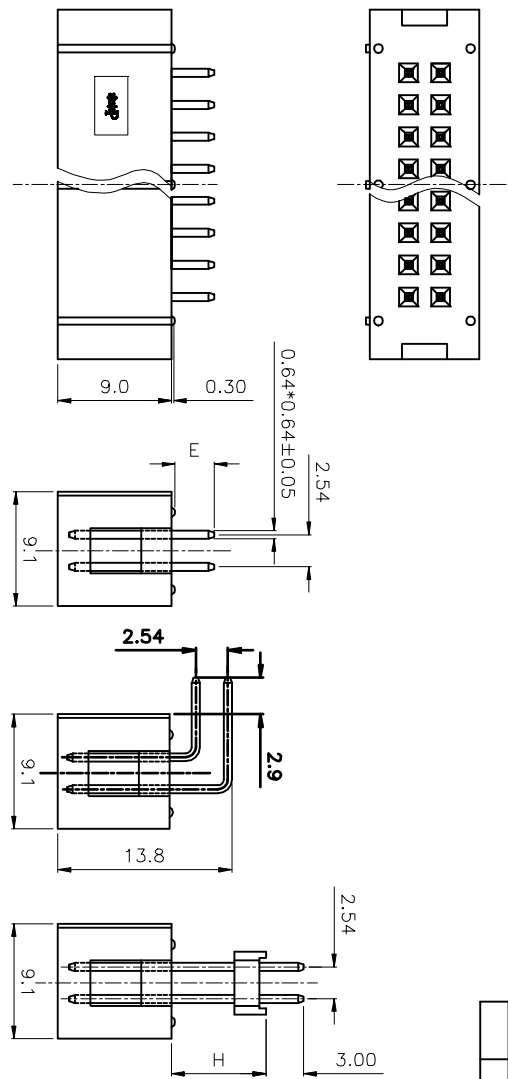

Dimension

Position	A	B	C	24P	38	35.8	27.94
6P	15.2	13	5.08	24P	38	35.8	27.94
8P	17.6	15.4	7.62	26P	40.6	38.4	30.48
10P	20.3	18.1	10.16	30P	45.6	43.4	35.56
12P	22.8	20.6	12.7	34P	50.7	48.5	40.64
14P	25.3	23.1	15.24	40P	58.4	56.2	48.26
16P	27.9	25.7	17.78	50P	71	68.8	60.96
18P	30.5	28.3	20.32	60P	84.1	81.9	73.66
20P	33	30.8	22.86	64P	89.2	87	78.74

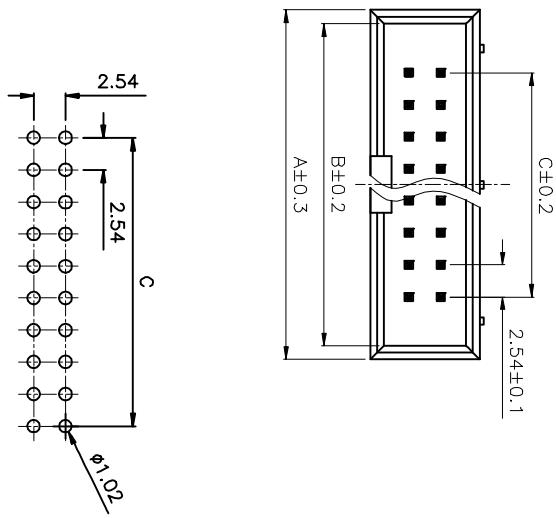
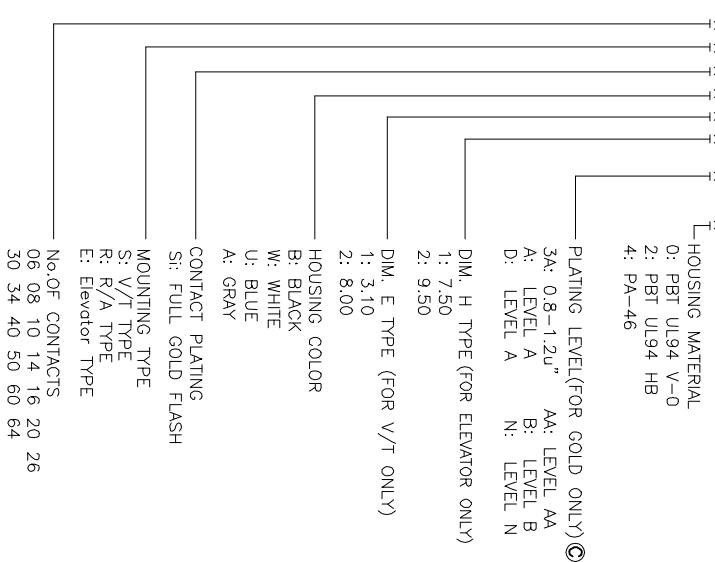

RECOMMEND PCB LAYOUT(TOLERANCE=±0.05)

GENERAL TOLERANCE	ANGLE TOLERANCE	±5°
X, ±0.60	X, ±3'	±5°
.X, ±0.38	.X, ±2'	±3'
.XX, ±0.25	.XX, ±1'	±2'

DRAWING TYPE	CUSTOMER	SHEET	1 OF 1
SCALE	1:1	SHEET	1 OF 1
DRAWING NO.			

PROJECTION	TITLE
UNITS	2.54mm BOX HEADER
SHEET SIZE	R/A, V/T & ELEVATOR TYPE
A4	LL1007-7

慈溪蓝翎电子有限公司
 CIXI LANLING ELECTRONICS CO., LTD.
 Tel: 86-574-63519038 Fax: 86-574-63517070