

REV.	DESCRIPTION	DRAWN	CHECKED	APPROVED
A	NEW RELEASE	ZQJ 11/18/2014		ZQJ 11/18/2014
B	ADD P/N CODE	CJJ 11/18/2014		

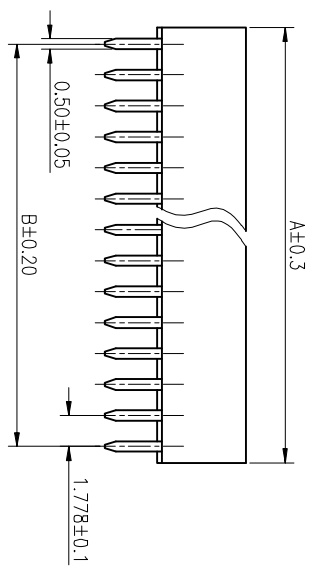
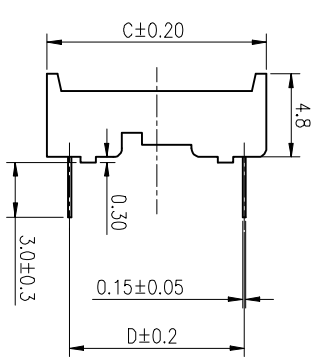
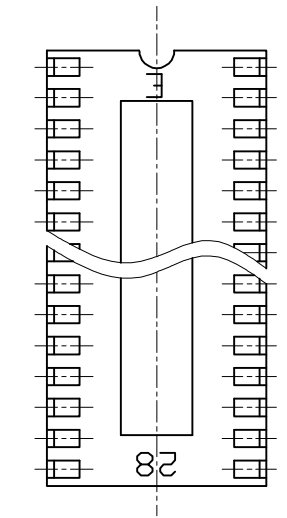

Table A:

Position	Dimension			
	A	B	C	D
24	21.34	19.56	12.65	10.16
28	24.89	23.11	12.65	10.16
30	26.67	24.89	12.65	10.16
32	27.45	26.67	12.65	10.16
40	35.56	33.78	17.73	15.24
42	37.34	35.56	17.73	15.24
48	42.67	40.89	17.73	15.24
52	46.23	44.45	17.73	15.24
56	49.78	48.01	17.73	15.24
64	56.90	55.12	21.54	19.05

NOTES:

- MATERIAL
 - INSULATOR: THERMOPLASTIC(UL 94V-0).
 - CONTACT: COPPER ALLOY.
 - CONTACT PLATED: SEE ORDERING INFORMATION.
- SPECIFICATION
 - TEMPERATURE: -20~+105°C.
 - CONTACT RESISTANCE: 20mΩ max.
 - INSULATION RESISTANCE: 1000MΩ min.
 - DIELECTRIC WITHSTANDING VOLTAGE: AC 500V PER MINUTE.

3. PRODUCT NUMBER CODE:



GENERAL TOLERANCE		ANGLE TOLERANCE		PROJECTION	
X.	±0.60	X.	±5°	UNITS	
.X	±0.38	.X	±3°	mm	
.XX	±0.25	.XX	±2°	SHEET SIZE	
DRAWING TYPE		CUSTOMER		A4	
SCALE		SHEET		SERIES	
DRAWING NO.		1 OF 1		LL1028	
TITLE					
IC SOCKET PITCH 1.778mm(0.070)					

慈溪蓝翎电子有限公司
CIXI LANLING ELECTRONICS CO., LTD.