

REV.	DESCRIPTION	DRAWN	CHECKED	APPROVED
A	NEW RELEASE	ZQJ 11/18/2015	~	ZQJ 11/18/2015
B	ADD P/N CODE	CJJ 11/18/2015	~	CJJ 11/18/2015

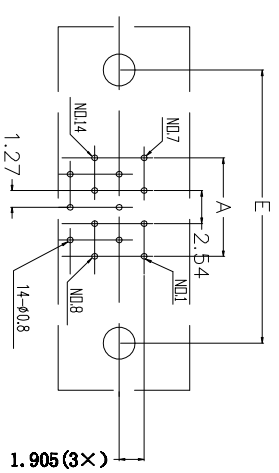
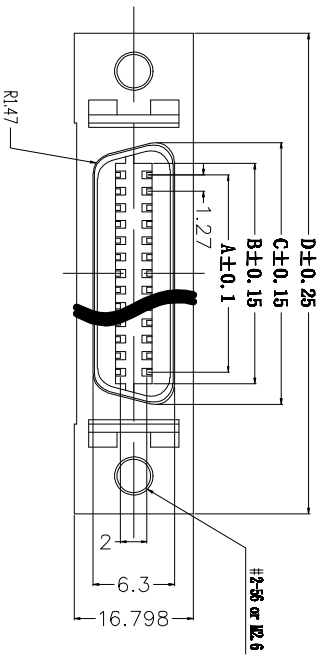
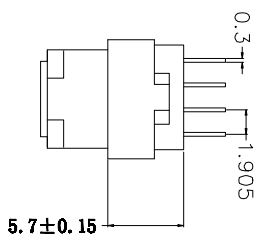
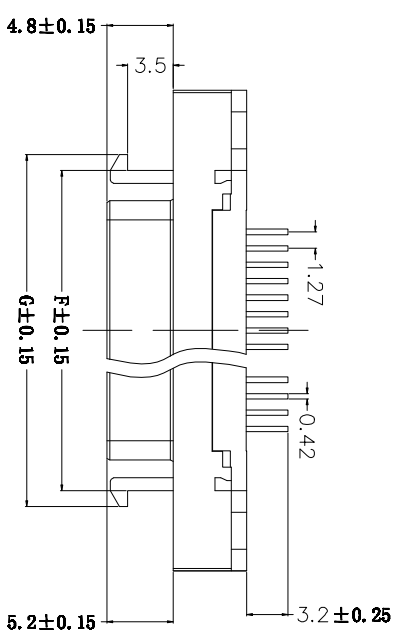
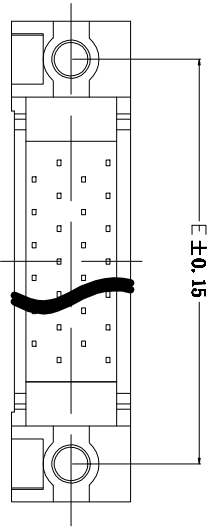

No. of pin	DIMENSIONS									
	A	B	C	D	E	F	G			
14	7.62	9.52	12.6	29.51	23.64	17.25	19.58			
20	11.43	13.1	16.43	33.32	27.45	21.06	23.39			
26	15.24	17.1	20.24	37.13	31.26	24.76	27.2			
36	21.59	23.4	26.5	43.48	37.61	31.11	33.55			
50	30.48	32.29	35.39	52.37	46.5	40.0	42.44			

SPECIFICATION
Housing: Thermoplastic, UL94V-0
Color: Black
Contact: Copper Alloy
Shell: Zinc Alloy
Voltage Current Rating: 0.5AMP, 250V AC
Insulation Resistance: 500M Min
Contact Resistance: 80m Max
Dielectric Withstanding Voltage: 500V AC
Temperature Range: -25°C ~ +70°C

GENERAL TOLERANCE	ANGLE TOLERANCE
X, ± 0.60	X, $\pm 5^\circ$
.X, ± 0.38	.X, $\pm 3^\circ$
.XX, ± 0.25	.XX, $\pm 2^\circ$

PROJECTION UNITS	TITLE
mm	SCSI Socket Connector
SHEET SIZE A4	SERIES LL1026-1

ITEM	PART NAME	SCALE	DRAWING NO.
2	CONTACT	1:1	ED
1	HOUSING	1:1	ED
1	PART NAME		

DRAWING TYPE	CUSTOMER	SHEET	1 OF 1
SCALE	1:1	SHEET	1 OF 1
DRAWING NO.			

慈溪蓝翎电子有限公司
CIXI LANLING ELECTRONICS CO., LTD.