

REV	DESCRIPTION	DRAWN	CHECKED	APPROVED
A	NEW RELEASE	ZQJ 11/18/2015	~	ZQJ 11/18/2015
B	ADD P/N CODE	CJJ 11/18/2015	~	CJJ 11/18/2015

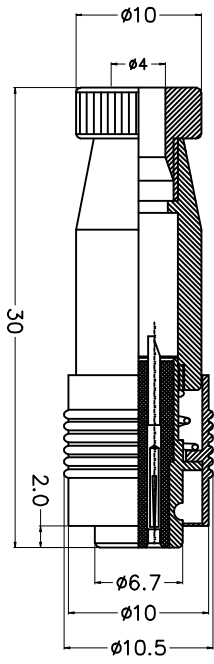

直式母插头 (镀锡-镀黑-镀金)
straight female plug
(Chrome plated-black chrome plated-gold plated)

XS7

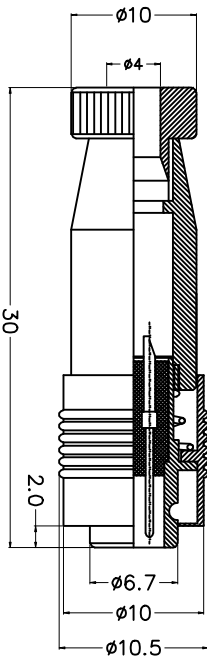

直式公插头 (镀锡-镀黑-镀金)
straight male plug
(Chrome plated-black chrome plated-gold plated)

数量	2	3	4	5
物料号/零件号 Part number	6+5	6+6	6+4	6+3
物料规格 Part specification	04.6	04.6	04.6	04.6
物料长度 Part length (mm)	2.5	2.5	2.5	2.5
物料外径 Part outer dia (mm)	110	110	110	110
物料内径 Part inner dia (mm)	1000	1000	1000	1000
物料重量 Part weight (g)	25	25	25	25
物料公差 Part tolerance (mm)	1500	1500	1500	1500
物料公差 Part tolerance (mm)	04.6	04.6	04.6	04.6

GENERAL TOLERANCE	ANGLE TOLERANCE
X. ±0.80	X. ±5°
.X ±0.88	.X ±3°
.XX ±0.25	.XX ±2°

CONTACT	HOUSING	DRAWING TYPE	CUSTOMER	SHEET	1 OF 1
1	1	SCALE	1:1	SHEET	1 OF 1
ITEM	PART NAME	DRAWING NO.			

PROJECTION	TITLE
UNITS mm	XS7 直式公插头 直式母插头
SHEET SIZE A4	SERIES XS7 Straight Male+Female Plug



慈溪蓝翎电子有限公司
CIXI LANLING ELECTRONICS CO., LTD.